



DRILL PUMP

TMC-06212

NEW STYLE PATENT
NO. M623716
OF TAIWAN, R. O. C.

PRODUCT FEATURE

- SELF-PRIMING WATER PUMP
- WORK WITH STANDARD GARDEN HOSE OR 3/4" HOSE USING ADAPTORS
- PUMP SHAFT DIAMETER 8mm
- WORK WITH STANDARD HAND DRILLS
- IDEAL FOR EMPTING AQUARIUMS, WATER TANK OR SMALL POOLS
- UP TO 320 GPH AT 1600 RPM
- STAINLESS STEEL AND GLASS FIBER INFUSED PLATES FOR STRUCTURAL RIGIDITY

SPECIFICATION

ROTATION	DELIVERY VOLUME	DELIVERY HEAD	SELF-PRIMING
400 RPM	80 GPH	2M	0.45M
1600 RPM	320 GPH	5M	1.3M

DIMENSIONS

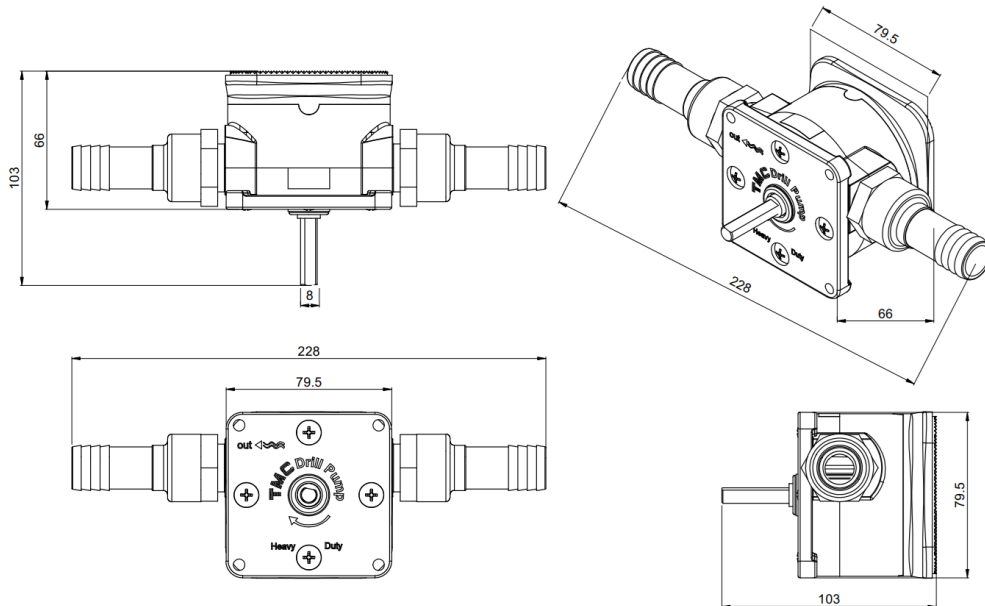

MOUNTING

- FIG. A – ATTACH INLET AND OUTLET HOSES SECURELY, USE THE INCLUDED ADAPTORS AS NEEDED. IF USING REGULAR 3/4" HOSE, MAKE SURE TO SECURE WITH HOSE CLAMPS (NOT INCLUDED)
- FIG. B- PLACE THE INLET HOSE INTO THE WATER AND DIRECT OUTLET HOSE TO DESTINATION.
- FIG. C – TIGHTEN THE DRILL CHUCK ONTO THE PUMP SHAFT

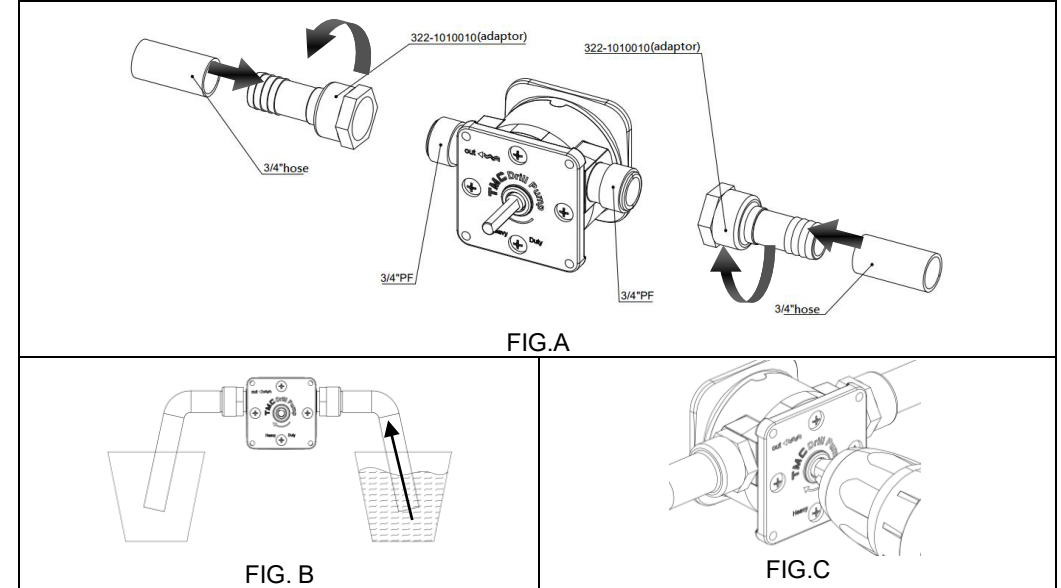

CAUTION

- DO NOT PUMP FLUIDS CONTAINING SAND, SLUDGE, OR ANY OTHER SOLID MATTER.
- DO NOT PUMP FLAMMABLE LIQUIDS SUCH AS GASOLINE, FUEL OIL, HIGHLY CONCENTRATED ALCOHOL, ETC.
- DO NOT RUN DRY
- DO NOT PUMP WITH ANY BLOCKAGE IN THE HOSES
- CONNECT YOUR DRILL TO A PROPERLY GROUNDED ELECTRICAL OUTLET TO PREVENT RISK OF ELECTRIC SHOCK.
- STOP DRILL PUMP OPERATION IMMEDIATELY IF THERE IS ANY SIGN OF OVERHEAT, SMOKE, OR FIRE.
- KEEP YOUR HANDS, FEET AND DRILL MOTOR DRY.

BEFORE USING THE TMC DRILL PUMP

- MAKE SURE THE DRILL CHUCK IS TIGHTENED ONTO THE PUMP SHAFT
- VERIFY DRILL ROTATION AND WATER FLOW DIRECTIONS
- MAKE SURE INLET HOSE IS PLACED INTO WATER
- MAKE SURE TO WEAR PERSONAL SAFETY PROTECTION EQUIPMENTS (GOGGLES, SAFETY SHOES, ETC.)

TMC TECHNOLOGY CORP.
No. 726, Jieh Shou Rd., Sec. 2, Pa Teh Dist., Taoyuan City, Taiwan, R.O.C.
E-mail: sales1@tmcint.com Website: www.tmcint.com